

RATCHET WIRE ROPE CUTTER



DESCRIPTION

Handheld Cable Cutter

This handheld cable cutter with a ratchet mechanism cuts flexible wire ropes up to 20 mm (3/4") diameter. The knives open in every direction and each part is replaceable. 17" long.

Part No.	Description	Size
80-901	Handheld Cable Cutter	17" (43.2 cm)
80-059-01	Blade, Ratchet, for Cutter Model #SCSZ20 (new style)	
80-059-02	Blade, Stationary, for Cutter Model #SCSZ20 (new style)	
80-901-01	Blade, Ratchet, for Cutter Model #HCS22 (old style)	
80-901-02	Blade, Ratchet, for Cutter Model #HCS22 (old style)	

Baudat Wire Rope Cutter

This cutter is for flexible copper and aluminum cables (K32) or fine-stranded (K32 Flex) up to Ø 32 mm. Not suitable for cutting steel-armored cables, aluminum alloys, and hard-drawn copper conductors.

Part No.	Description	Size
80-155	Baudat Wire Rope Cutter Model #K32	

Kabelscheren
Cable cutter
Coupe cables

HC 58/55/38

Seilschere
Wire rope cutter
Cisailles coupe-câble

HCS 22

Gebrauchsanleitung · Instruction bulletin · Mode d'emploi



Keine Gliedmaßen im Schneidebereich!
Keep your fingers away from the blade!
Ne mettez pas vos doigts dans la zone de coupe!

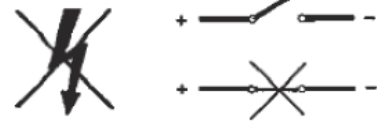

Strom abschalten · Switch off current · Couper l'alimentation électrique

HC 58 Cu + Al bis max. 58 mm \varnothing Cu-Kabel max. 450 mm² Al-Kabel max. 500 mm²
HC 55 Cu + Al bis max. 55 mm \varnothing Cu-Kabel max. 450 mm² Al-Kabel max. 500 mm²
HC 38 Cu + Al bis max. 38 mm \varnothing Cu-Kabel max. 300 mm²

- Nicht geeignet für feindrähtige Cu-Leitler, stahlfarnierte Kabel, Aluminiumlegierungen und hartgezogene Kupferleiter
 - Not suitable for flex. Cu-Conductors, steel armoured Cable, aluminium alloys and hard copper conductors
 - Non approprié pour conducteur cuivre souple (RNF), câble armé acier, alliage aluminium et conducteur cuivre rigide (ROZV)

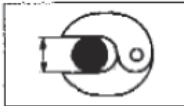

HCS 22 flexible Drahtseile \varnothing 18 mm
 flexible wire ropes
 câbles métalliques flexibles
 Niro- und hochverdichtete Drahtseile \varnothing 14 mm
 Niro- and hard drawn wire ropes
 Câbleâme Acier Inox (acier nickel-chrome) et acier dur
 Kabelscheren nur bestimmungsgemäß verwenden!
 Use cable cutters only the purpose for which they are intended!
 Respecter les capacités de coupe!

Schneidleistung · Cutting capacity · Capacité de coupe

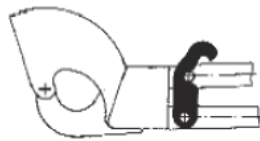

Transport
How to lock
Comment Verouiller les manches



Schneiden
How to cut
Comment couper



Öffnen
How to open
Comment ouvrir

Arbeitsweise · Catch position · Mode d'utilisation



Nicht schräg schneiden · No diagonal cutting · Ne pas couper en biais



bewegliche Teile ölen
oil movable parts
huiler les parties mobiles

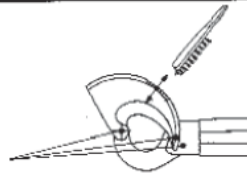

Verzahnung bürsten
Brush ratchet teeth
Brosser la cremailleur

Pflege / Wartung · Maintenance · Entretien

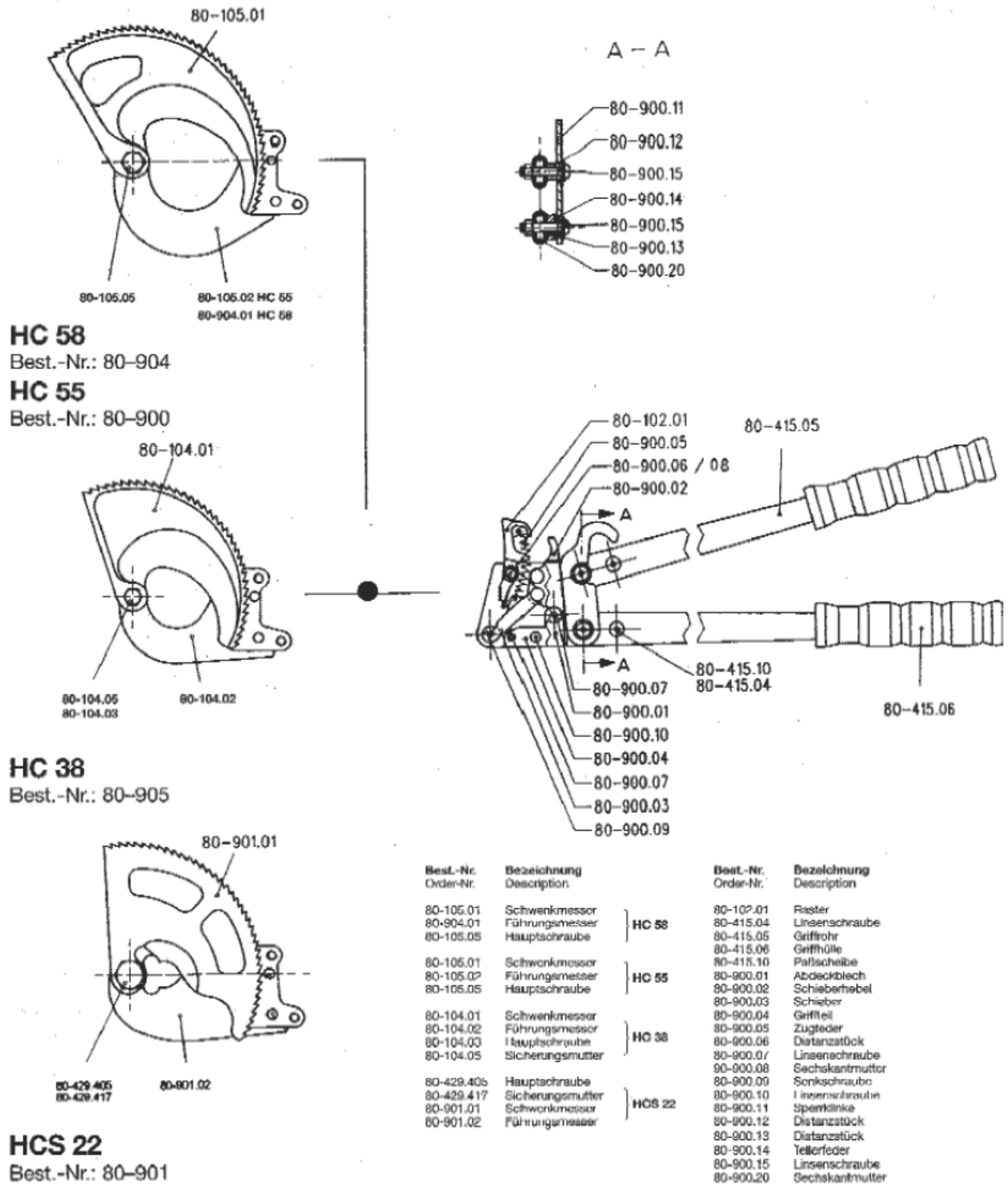

Nur Original BAUDAT-Ersatzteile verwenden! Use only original BAUDAT spare part! N' Utiliser que de pieces detachees d'origine BAUDAT!